

- Taglienti per grader
- Cutting edges for graders
- Grader-Messer
- Lames pour grader

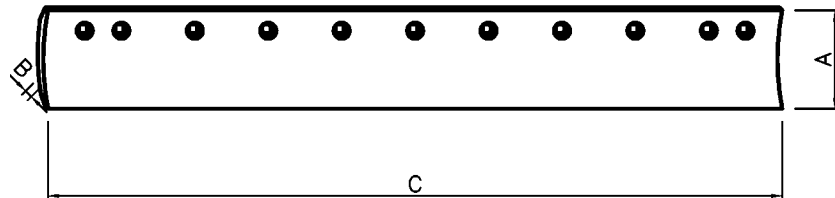

N. ORIGINALE ORIGINAL P/N ORIGINAL-NR. N. ORIGINAL	PESO (KG) WEIGHT GEWICHT POIDS	DIMENSIONI - DIMENSIONS ABMESSUNGEN - DIMENSIONS				N. FORI HOLES BOHR. TROUS	MODELLO MODEL MODELL MODELE
		A (mm)	B (mm)	C (mm)	Ø Bolt (")		
232-70-12142	23,8	152	13	1828	5/8	8	GD310RC-3A, GD500R-1
232-70-12143	29,8	152	16	1828	5/8	13	GD523A-1, GD525A-1, GD505R-2 GD623A-1, GD625A-1, GD605R-3 GD37-6H, GD40HT-2, GD655R-3
232-70-12650							GD310RC-3A, GD500R-1
232-70-12651							GD37-6H, GD40HT-2, GD505A-2 GD505R-2, GD600R-3, GD605A-3 GD605R-3, GD650R-3, GD655A-3
232-70-52940							GD37-6H, GD655R-3, GD505A-2 GD505R-2, GD600R-3, GD605A-3 GD605R-3, GD650R-3, GD655A-3
232-70-52850	51,4	203	19	1828	5/8	13	
232-70-52970							GD37-6H, GD40HT-2, GD505A-2 GD505R-2, GD600R-3, GD605A-3 GD605R-3, GD650R-3, GD655A-3
232-70-52910							GD37-6H, GD40HT-2, GD505A-2 GD505R-2, GD600R-3, GD605A-3 GD605R-3, GD650R-3, GD655A-3
232-870-6310							GD310RC-3A, GD500R-1
233-70-12141	19,8	152	13	1523	5/8	7	GD30-5M, GD28AC-1 GD300A-1, GD405A-1 GD31RC-3A

Tutti i numeri, simboli, e denominazioni originali sono usati soltanto per riferimento, e non si deve in alcun modo intendere che i pezzi elencati siano originali.
All manufacturers' name, numbers, symbols and descriptions are used for reference purpose only, and it is not implied that any part listed is the product of these manufacturers.

- Taglienti per grader
- Edges for graders
- Grader-Messer
- Lames pour grader

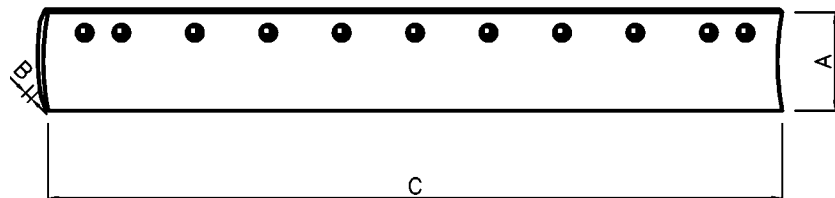

N. ORIGINALE ORIGINAL P/N ORIGINAL-NR. N. ORIGINAL	PESO (KG) WEIGHT GEWICHT POIDS	DIMENSIONI - DIMENSIONS ABMESSUNGEN - DIMENSIONS				N. FORI HOLES BOHR. TROUS	MODELLO MODEL MODELL MODELE
		A (mm)	B (mm)	C (mm)	Ø Bolt (")		
233-70-12450							GD30-5M, GD28AC-1 GD300A-1, GD405A-1 GD31RC-3A
233-870-6120							GD28AC-1, GD300A-1
234-70-12192	27,8	152	13	2133	5/8	9	
234-70-12193	34,2	152	16	2133	5/8	15	GD705R-2, GD40HT-2
234-70-12250							GD705A-3
234-70-12450							GD705R-2
234-70-12510							GD705R-2
234-70-12550							GD705A-4
234-70-12580							GD40HT-2, GD705R-2
234-70-12640							GD705R-2
234-70-12670	60	203	19	2133	5/8	15	
234-70-12710	49,4	203	16	2133	3/4	15	GD725A-1
234-70-16130							GD705A-4
234-70-16290							GD705A-4
234-70-16410							GD705A-4
234-70-16420							GD705A-4
234-70-32620							GD705A-4
235-70-12140	68,6	203	19	2438	3/4	17	GD825A-1
236-70-22120							GD22H-1, GD22AC-1, GD200A-1
237-70-12120							GD28AC-1, GD300A-1
238-70-12220	24,5	152	16	1523	5/8	11	GD28AC-1, GD300A-1

Tutti i numeri, simboli, e denominazioni originali sono usati soltanto per riferimento, e non si deve in alcun modo intendere che i pezzi elencati siano originali.
All manufacturers' name, numbers, symbols and descriptions are used for reference purpose only, and it is not implied that any part listed is the product of these manufacturers.